

Basic Slides

Basic linear slides are just that...basic. They are easy to understand, install and get the job done. Basic Slides come in 3 sizes and offer 2 carriage sizes: single (2 bearings) and double (4 bearings). The end support blocks offer a simple clamping and mounting design in one. Lastly, you can choose between 2 bearing packages: steel linear ball bearings or our Minuteman Teflon Composite, Self-Lube linear bearings. Basic slides offer some special options:

- Lightweight ceramic coated aluminum shafting (only when used with Minuteman Teflon Composite Bearings™)
- FDA/USDA/Washdown Compliant Ceramic Coated Aluminum Carriage Plate, Shafting, End Support Blocks and Minuteman White Teflon Composite Bearings™

Bearing Package:



You have the option of using a steel jacketed linear ball bearing or our Minuteman Composite, Self-Lube bearing. To see the difference between them, visit: http://www.lm76.com/minuteman_vs_linear_ball.htm

Basic Linear Slides come standard with hard chrome plated shafting so corrosion is never an issue.

Basic Slides can be easily mounted in multiple axis configurations. Ask our engineering staff for more details.

Loading:

P/N	Load N	Load lbs.
BS6-S x?	44.5	10
BS6-D x?	89	20
BS8-S x?	47	10.5
BS8-D x?	95	21
0BS12-S x?	127	28.5
BS12-D x?	127	28.5

Basic Slides employ unsupported shafting and are more prone to shaft deflection than fully supported shaft assemblies – particularly with longer travels. Therefore, we recommend you design around the above load values.

Ordering P/N

Part Number Key:

BS6-S x Required Travel

Slide OAL Length = Width of End Blocks x 2 + Carriage Block Length + Stroke

BS	6	S	D	Travel Stoke	Bearing Style
Basic Slide	6mm Shaft Hard Chrome Plated Steel	Single Block	Double Block	2 inches	<p>M = Minuteman Teflon Composite Linear Bearing</p> <p>B = Linear Ball Bearing</p>

Basic Slides come in kit form. LM76 will cut shafting to the length needed.



SolidWorks 3D Models are available upon request: Patrick@LM76.com

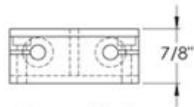

Assembled

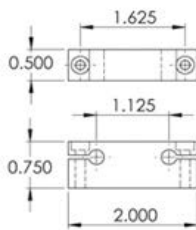
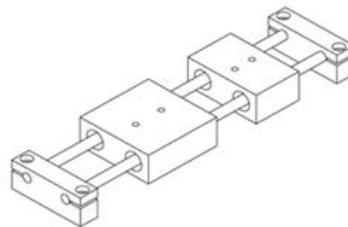

End Block

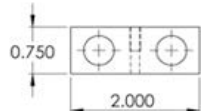
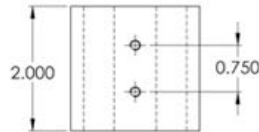

Double Block

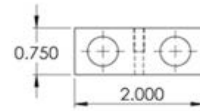
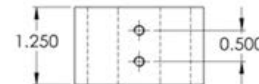

Single Block

BS6 SLIDE

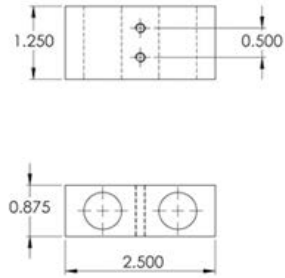
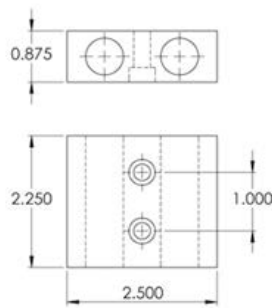
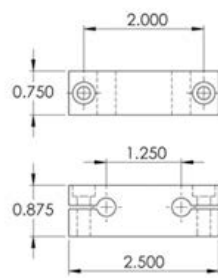
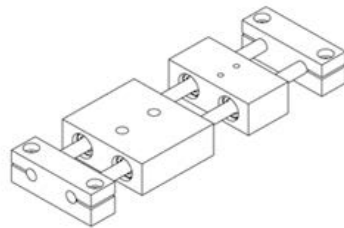
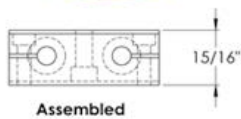

BS8 SLIDE

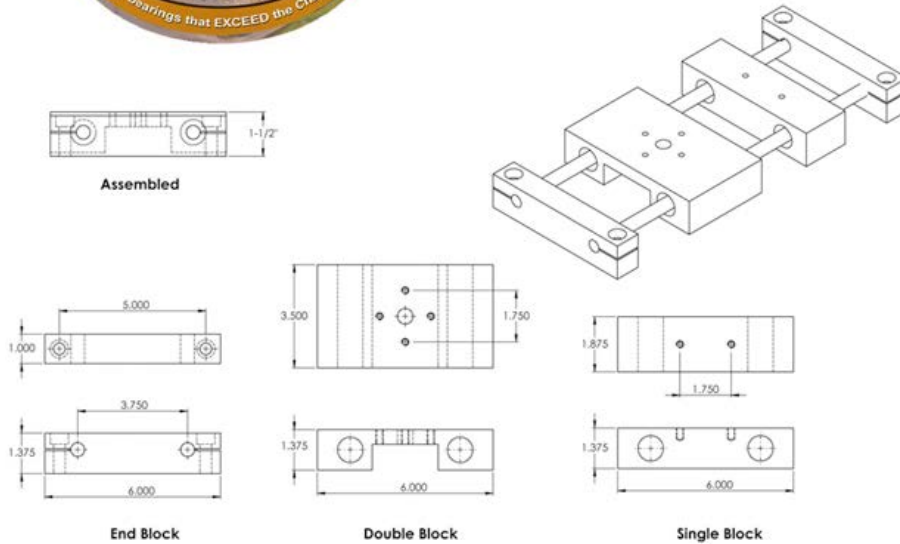

BS12 SLIDE

PRICE

Slide Overall Length/Shaft OAL = Width of End Blocks x 2 + Carriage Block Length + Stroke

Basic Slide Pricing Schedule
 Choose your size - get your price - and order.
It's that simple!

P/N	Single Carriage	Double Carriage	End Support Blocks x 2	Shafting Per Inch
BS6	\$ 22.82 ea.	\$ 34.34 ea.	\$ 25.29 ea.	\$1.00 per inch
BS8	\$ 26.14 ea.	\$ 39.10 ea.	\$ 28.00 ea.	\$1.20 per inch
BS12	\$ 59.36 ea.	\$ 102.82 ea.	\$ 91.68 ea.	\$1.30 per inch

More Linear Motion Products from LM76:

